

# PROXXON

## *Tools with character!*

*2005/2006  
Includes new products!*



**Manufactured in the world's largest socket and spanner factory,  
utilising the most modern production techniques.**



Herstellung nach  
Certificate of Registration  
File No: A10048 vom 09.02.01  
ISO 9001:2000

1/2

INTERNATIONAL DESIGN  
PATENT-NO DM031271

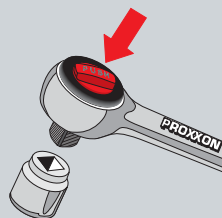

**Quick release button releases socket instantly:**

A feature you will appreciate in every day use.

**DIN  
ISO**

**Quality at its best:**

Highest quality, exceeds DIN/ISO requirements for hardness and maximum torque. Individual size tolerances are all well within the prescribed norms.

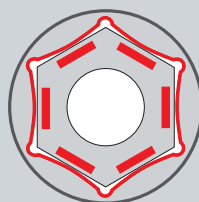

**The PROXXON driver system:**

The driving force is transferred to the sides of the nut or bolt, not the corners. This ensures high power transfer without damaging the corners of the nut or bolt.

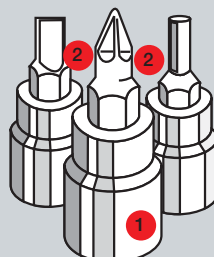

**Screwdriver bits:**

With CrV socket **1**.  
The drive bits are all an optimum combination of chrome-silicon manganese-molybdenum steel. **2**.

All bits and accessories are forged using 31CrV steel. High carbon content to ensure consistent hardness. **3**  
Deep, uniform forging is guaranteed on the hex. drive side **4** to ensure that protruding studs do not present a problem. Thin-wall construction **5** for better access while maintain strength for heavy work. Lead-in chamfer **6** allows socket to slide over nuts easily. Machined fits on drive square **7** allow ratchet to arrest properly. Beginning with the 19 mm size the outer diameter of the sockets is reduced on the drive square end for improved handling **8**. Double nickel-plating and single chrome-plated finish provide optimum surface protection.

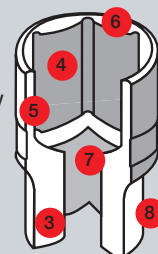

Inseparable handle with patented injection moulded (EP03101656/1), oil and acid-resistant NEOPRENE. With hole for hanging.



Socket sizes easy to read – even after 20 years worth of use!

**2 year  
guarantee**

Even when used professionally.

Sockets and drive elements carry an additional  
**25 year guarantee** against faulty materials and manufacturing faults.

**PROXXON  
INDUSTRIAL**

## The heart of a socket set: The ratchet.

## Now with push button socket release.



The Ratchet:

is made from one single element, i.e. the head is not welded on ①.

Quick release button releases socket instantly when pressed ②.

Perfect teeth, suitably hardened for maximum life expectancy ③.

Reliable drive direction mechanism simultaneously engages numerous teeth to ensure optimal torque transmission ④.

The appropriate tightening torque and socket size are indicated in the table of bolt diameters (1.6 to 24mm) located in the lid of all socket sets offered at the right.

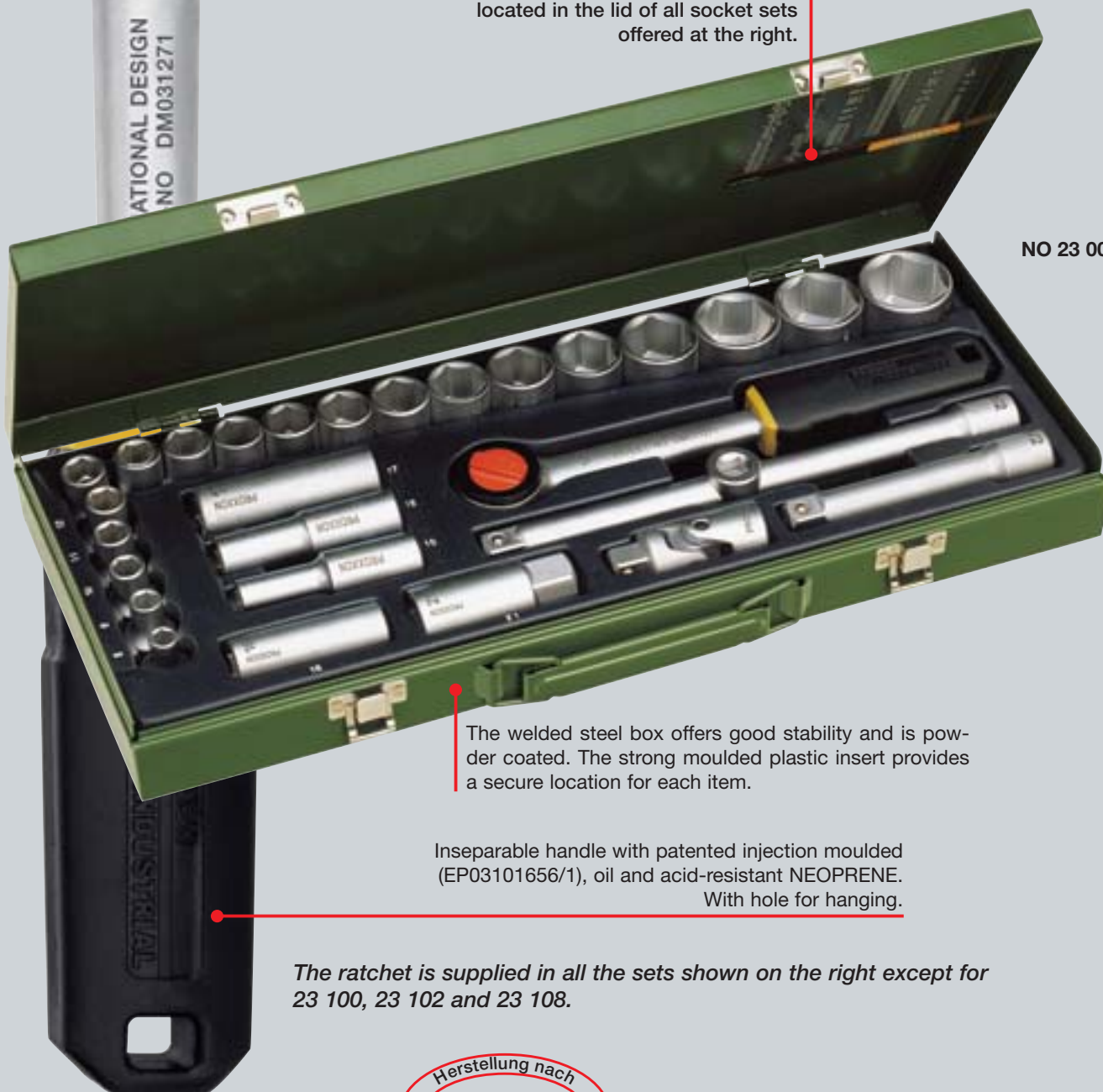

NO 23 000

The welded steel box offers good stability and is powder coated. The strong moulded plastic insert provides a secure location for each item.

Inseparable handle with patented injection moulded (EP03101656/1), oil and acid-resistant NEOPRENE. With hole for hanging.

The ratchet is supplied in all the sets shown on the right except for 23 100, 23 102 and 23 108.





## **Socket sets in chrome vanadium steel.**

### **Standard series in sturdy, powder coated steel boxes.**



**For mechanics who need power. 29 piece set, with 8 to 34mm sockets.**

For/with 1/2" square drive, with 34mm socket (22mm socket meets new ISO standard). Deep sockets for protruding bolts. 16 and 21mm spark plug sockets.

[See photo for other items.](#)

**NO 23 000**



**55 piece complete set with 1/4" and 1/2" ratchets.**

Contains sockets from 4mm to 32mm and 16/22mm spark plug sockets, screwdriver bits with square drive for slotted, Phillips, Torx and Allen sockets and 1.25 - 1.5 - 2.0 - 2.5 and 3mm Allen keys.

[See photo for other items.](#)

**NO 23 040**



**Automotive socket set with 1/4" and 1/2" ratchets. 27 piece set.**

Suitable for all common sizes between 6mm and 32mm. Also contains 16 and 21mm spark plug sockets.

[See photo for other items.](#)

**NO 23 020**



**Compact set with 3/8" drive for 6 - 24mm sockets. 20 pieces.**

Set include 16 and 21mm spark plug sockets.  
[See photo for other items.](#)

**NO 23 110**

**High quality tools for industry,**

**workshop and construction at a really great price.**



**Precision engineer's set with 1/4" square drive. 36 piece set.**

Includes 4 - 13mm sockets, screwdriver bits with square drive for slotted, Phillips and Allen sockets and 1.25 - 1.5 - 2.0 - 2.5 and 3mm Allen keys. Just compare the value.

[See photo for other items.](#)

**NO 23 080**



**35 piece screwdriver/socket set with magnetic adapter.**

For use with drill. 4 - 13mm sockets (1/4" drive). Including 16 high quality alloy Allen key bits and adapters for male hex and square bits (magnet to socket adapter) and female hex and square bits (ratchet to screwdriver bit adapter) and 1.25 - 1.5 - 2.0 - 2.5 and 3 mm. Allen keys.

[See photo for other items.](#)

**NO 23 070**



**23 piece TORX socket set.**

This set contains 1/4" drive TORX sockets in sizes TX8 to TX30 and external TORX sizes E4 to E8 (all suitable for drive torque up to 10Nm), 1/2" drive TORX sockets in sizes TX40 - 60 and external TORX E10 to E18 (for torque from 25 to 135Nm) and three offset spanners - the TX6, 8 and 10.

[See photo for other items.](#)

**NO 23 102**



**9 piece socket set for safety screws with tamper-resistant cylindrical head and 1/4" square drive.**

8 attachments (with hole in end), sizes TX8 to TX40. Screwdriver handle with square drive and square socket at top of handle (for attaching ratchet). Torx screws illustrated not included in set.

[See photo for other items.](#)

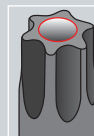

**NO 23 108**



**18 piece Allen key socket set.**

This 18 piece set offers 1/4" drive for torque to 10Nm in sizes 2 - 6mm. The 1/2" drive offers torque of 25-210Nm in sizes 6 - 14mm (short version of 55mm) and 5 - 12mm (long version of 100mm)

[See photo for other items.](#)

**NO 23 100**

*Note: Our super safety and specialty bit set (75-piece) is described in detail on page 20 of this catalogue.*



**Composition and design copyright by PROXXON.**

High strength plastic case with secure sliding locks for easy opening and closing. Each part embossed with size or symbol. Thread table on cover.



**Complete set with S and L baton ratchets (1/4" and 1/2")**

This 65 piece set offers sockets from 4 to 34mm, as well as 16 and 21mm spark plug sockets. Screwdriver bits with square driver for slotted, Phillips, TORX and Allen sockets. Allen keys 1.25 - 1.5 - 2.0 - 2.5 and 3mm. Four extensions, one screwdriver handle with square drive, two universal joints. Screwdriver handle with square drive for slotted, Phillips, TORX and Allen sockets.

See photo for other items.

**NO 23 286**

\*\* Same components also available for screws with Imperial (inch) dimensions. See page 9!

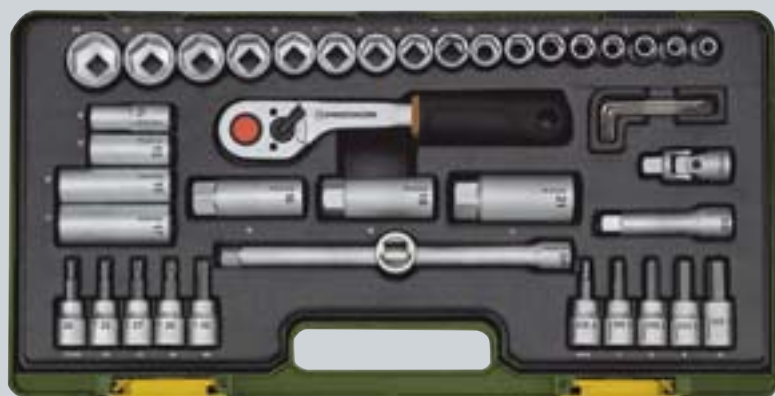

**Compact set with baton ratchet M (3/8")**

This 44 piece set offers sockets from 6 - 24mm. Deep sockets 10 - 17mm for protruding bolts. Spark plug sockets for 16, 18 and 21mm, T-bar and two extensions. Screwdriver bits with square drive for Allen screws 4 - 10mm and TORX screws (20 - 40). Five Allen keys 1.25 - 1.5 - 2.0 - 2.5 and 3mm.

See photo for other items.

**NO 23 282**



**Special set for TORX screws, for 1/4" and 1/2" drives. 36 piece set.**

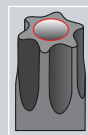

With 1/4" square drive (for torques under 25 Nm). Screwdriver bits for TX8 and TX40 (all tamper-resistant with hole in end for use with TORX safety screws). For male TORX screws (E4 - E10) normal version (25mm), as well as E08 and E10 long version (50mm) for deep set bolts.

With 1/2" square drive (for torques over 25Nm), screwdriver bits TX45 - TX60 short version (55 mm) and also long version (100mm) for male TORX screws E12 - E24 (short version (40mm) as well as E12, E14 and E16 long version (80mm) for deep set bolts. Also included: FELO screwdrivers for TX8 - TX25.

For other items see picture.

**NO 23 288**



## Baton ratchets.

## Heart of the new PROXXON INDUSTRIAL socket sets.

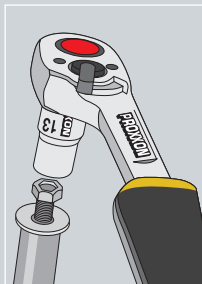

**2 YEAR**   
**GUARANTEE**

Even when used professionally.

Asymmetrical shape improves view when attaching.

**20 piece special socket set with deep sockets.**



**49 piece precision engineer's set with baton ratchet S (1/4").**



**41 piece special set for TORX and Allen screws.**



Quick-release button release socket instantly.

Perfect teeth, suitably hardened for maximum life expectancy. Reliable drive direction mechanism simultaneously engages numerous teeth to ensure optimal torque.

With a 1/4" square drive (for torque under 25Nm), hexagonal sockets for 4 - 5 - 5.5 - 6 - 7 - 8 - 9 - 10 - 11 and 12mm.

With a 1/2" square drive (for torques over 25Nm): 13 - 14 - 15 - 16 - 17 - 18 - 19 - 20 - 21 - 22 and 24mm. All parts are matt chrome-plated and are clearly labelled.

See photo for other items.

**NO 23 292**

This set includes sockets from 4 - 13mm, deep sockets from 6 - 10mm for protruding bolts and screwdriver bits with square drive for slotted, Phillips, Allen and TORX screws. It also has external TORX sizes 4 - 8, T-bar, 2 extensions, screwdriver handle with square drive and 1.25 - 1.5 - 2.0 - 2.5 and 3mm Allen keys.

See photo for other items.

**NO 23 280**

This set offers a 1/4" drive for torques below 25Nm. Screwdriver bits, Allen key screws from 2 - 6mm, TORX sockets for sizes 8 to 40 and external TORX E4 to E8. The 1/2" drive (for torques over 25Nm) has Allen key bits for 7 - 14mm (short version - 55mm) and 6 - 12mm (long version - 100mm), TORX sockets TX46 - 60 (short version) and external TORX E10 to E18, plus 1.25 - 1.5 - 2.0 - 2.5 and 3mm Allen keys.

See photo for other items.

**NO 23 290**



*If you are looking for the best automotive tool set,  
don't waste your time looking further.*

**PROXXON**

**INDUSTRIAL**

12 piece matt ring/open-end  
CrV steel spanners.  
To DIN 3113.

Sockets and drive elements  
made of CrV steel.

Switchable ratchet with release mechanism,  
made from a single piece.

**10 YEAR  
GUARANTEE**

Even when used  
professionally.

Sockets and drive elements carry an additional  
25 year guarantee  
for material and workmanship.

High quality, non-crushable,  
impact resistant case made of oil  
and acid resistant plastic.



## Automotive and universal tool set Practically equipped with first class tools.



Knipex Water pump pliers with through-lock system.



FELO screwdrivers (type 600) - with ball grip for maximum torque.

PROXXON

INDUSTRIAL

Ball-pein hammer (300g), with graphite handle for unexceeded vibration damping, handy non-slip grip.

12 piece ring/open-end spanners meet DIN 3113, made of CrV steel, sizes 6 - 15, 17 and 19mm. Knipex 180mm combination pliers and 240mm water pump pliers. Felo screwdriver set with one each slotted sizes 8.0 x 1.2; 5.5 x 1.0 and 3.0 x 0.5mm and Phillips size 2 as well as two stubby screwdrivers: One Phillips size 2 and slotted screwdriver 5.5 x 1.0mm. Automotive light tester with cable and crocodile clip (for automotive electrical systems only). Sockets, sizes 8 - 10 - 12 - 13 - 14 - 15 - 17 - 19 - 22 and 24mm. Switchable ratchet, universal joint, one each 125 and 250mm extensions. Long T-handle with slider (for loosening lug nuts). Special 16 and 21mm spark plug sockets with ball head on longitudinal side. Allen keys, sizes 5 - 6 - 8 and 10mm. PROXXON ball-pein hammer (300g), ground on all sides and partially polished, inseparable graphite handle (fibre-glass reinforced), slip-resistant soft coating in holding area) for unexceeded vibration damping.

Specific location for each tool in practical, tough plastic carrying case.

**NO 23 650**

**The imperial master piece.**  
**For inch sizes. With 1/4" and 1/2" baton ratchets.**

**NEW**

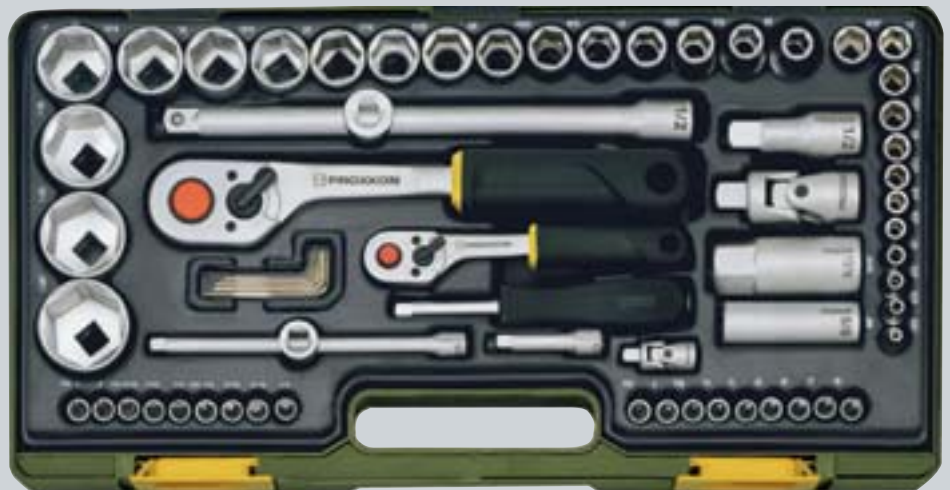

**65 pieces. With 5/32" to 1 3/8" sockets.**

5/8" and 13/16" spark plug sockets. Screwdriver bits with square drive for slotted screws, Phillips screws, TX screws and HX screws. Allen keys (offset) for 0.05", 1/16", 5/16", 3/32" and 1/8" Allen screws. Four extensions. One screwdriver handle with drive square. Two universal joints.

See photo for other items.

**NO 23 294**



High quality combination pliers of CrV steel.



## New 1/4" ROTARY ratchet.

**With turn handle for fine tightening!**

**2 YEAR ●  
GUARANTEE**

Even when used professionally!

With quick-release button  
(press button to release  
attachment instantly) and  
reliable ratcheting  
direction reversing mechanism.



Fine tooth drive (52 teeth)  
ensures normal  
ratchet function.

Handy grip with two  
component material, human  
engineered to facilitate work.

**Problem:**

A loose bolt or nut cannot be  
screwed off, because it turns  
back and forth with the ratchet.  
It is too loose to actuate the  
ratcheting mechanism.

**Solution:** With our ROTARY  
ratchet you can simply turn  
the handle!



**No space for ratcheting? For example on automo-  
tive heating and air conditioning systems?**

No problem with our ROTARY ratchet. Just turn the handle to tighten  
right up to the stop on one side. Just a few millimetres are enough to  
tighten or break. Rotating the handle suffices in "idle".

NO 23 082

**The solution to your problem: Open ratchets and sockets  
(allow bolts to extend through). 13 to 27mm.**



**Special workshop set, 11 piece**

13 - 27mm sockets. With ratchet and extension (75mm). The open design allows bolts to be countered from the top. Nuts can be "screwed all the way down" on long threaded rods. Particularly advantageous when working on tie rods, shock absorber nuts and for installing pulleys on alternators. In powder finished steel case with shaped insert.

NO 23 600



Open socket: For work with long  
threaded bolts and screws. The  
socket rests on the nut and does  
not slip downwards.



Used with shock absorber  
(usually 22mm).

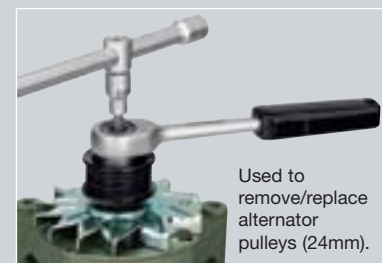

Used to  
remove/replace  
alternator  
pulleys (24mm).

**Extremely small head, slender handle**

**and fine teeth help in tight places.**

**2 YEAR ●  
GUARANTEE**

Even when used professionally!

### **MICRO ratchet**

Fine-toothed. Several teeth grip simultaneously allowing the ratchet to operate in spaces where it can rotate only 5 degrees. With one finger reversing level for ratcheting direction, and push button release for socket. Single piece head and shaft of CrV steel. Matt chrome-plated finish.

**NO 23 164 1/4" square drive**

**NO 23 166 3/8" square drive**

**NO 23 168 1/2" square drive**

### **MICRO 1/4" flex-head ratchet**

Can be arrested in all positions. Extremely small head (dia. 19mm). Ideal for "tight spots" particularly on dash-boards (when removing or installing), replacing wind-screens and on air-conditioning equipment. Also suitable for bolts "around the corner". Head swivels 90° to both sides. With push button arrest in 14 positions. Perfect fine-tooth ratcheting (72 teeth). One-finger reversing lever for changing ratcheting direction. Quick-release button releases socket instantly.

**NO 23 162**

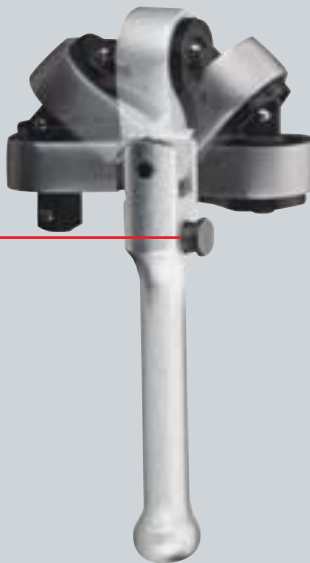
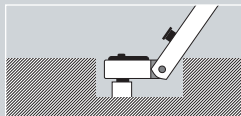
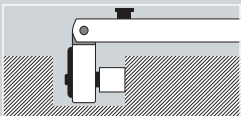

Button for locking and releasing extension.



All PROXXON INDUSTRIAL ratchets are equipped with a quick-release button for releasing attachments instantly.



Twist ring to open and close.

### **Locking extensions for 1/2" drive.**

One each 125, 250 and 350mm. Important for tight spaces where socket could be lost. For work on oil filters, exhaust systems, engines, drive shafts, gears and with deep set spark plugs (together with special spark plug socket set). It is also useful with wide bolts and with sockets with a high net weight. Forged from CrV steel, double nickel-plated with matt chrome finish. Packed in practical reinforced plastic carrying case.

**NO 23 340**



1/4"

**High quality ratchets, sockets, and accessories**

**for all mechanics. 31 CrV 3 chrome-vanadium steel.**

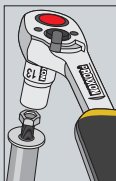

**Baton ratchet S (small) 1/4". Our sturdy ratchet!**

Fine tooth drive: Several teeth engage simultaneously for transferring maximum torque. Reversing lever for ratcheting direction. Quick-release button for releasing sockets instantly. Head and shaft forged from one piece of CrV steel. Double nickel-plated with matt chrome-plated finish. Grip of oil and acid resistant NEOPRENE with practical hole for hanging up.

**NO 23 330**

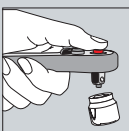

**Ratchet 2000 S (small) 1/4". Our extremely flexible ratchet!**

With handy, soft-touch Dupont HYTREL grip and practical hole for hanging up. Precision ratchet drive for long service life and high torque. Reversing lever for ratcheting direction. Quick-release button for releasing sockets instantly.

**NO 23 170**

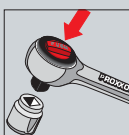

**Standard ratchet S (small) 1/4". Proven 100,000 times over!**

With reversing feature directly on ratchet mechanism. Several teeth engage simultaneously for transferring extremely high torque. Quick-release button for releasing sockets instantly. Head and shaft forged from one piece of CrV steel. Double nickel-plated with matt chrome-plated finish. Grip of oil and acid resistant NEOPRENE with practical hole for hanging up.

**NO 23 092**

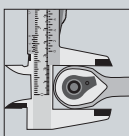

**MICRO ratchet S (small) 1/4". The slender ratchet with fine teeth!**

With extremely small head. Perfect fine-tooth drive for ratcheting action even when turned only 5°. Reversing lever for changing ratcheting direction. Quick-release button releases socket instantly. Head and shaft forged from one piece of CrV steel. Double nickel-plated with matt chrome-plated finish.

**NO 23 164**



**1/4" Magnetic holder for hexagonal bits**  
with male and female hex. shafts. Ideal for working with electric screwdrivers and drills.

Size	Part NO
	23 703



**1/4" T-bar with slider**

23 704



**1/4" extension**

50 mm	23 707
100 mm	23 708
150 mm	23 705



**1/4" flexible extension**

150 mm 23 706



**1/4" screwdriver grip with square drive**  
140mm long

23 702



**1/4" universal joint**

23 709



**1/4" adapter for hexagonal bits** ①  
(DIN 3126) female square to female hexagon

23 780

**1/4" adapter** ②  
1/4" female square to 3/8" male square

23 782

**1/4" adapter** ③  
with 1/4" female square to 1/4" male hexagon.

23 701



#### 1/4" sockets

Size	Part NO
4 mm	23 710
4.5 mm	23 711
5 mm	23 712
5.5 mm	23 713
6 mm	23 714
6.5 mm	23 715
7 mm	23 716
8 mm	23 718
9 mm	23 720
10 mm	23 722
11 mm	23 724
12 mm	23 726
13 mm	23 728
14 mm	23 729



#### 1/4" Allen sockets

Head made of chrome silicon manganese molybdenum steel.  
Socket CrV steel.

2 mm	23 744
2.5 mm	23 746
3 mm	23 743
4 mm	23 745
5 mm	23 747
6 mm	23 749
8 mm	23 751



#### 1/4" Deep sockets

For long protruding bolts

4 mm	23 767
5 mm	23 768
5.5 mm	23 769
6 mm	23 770
7 mm	23 772
8 mm	23 774
9 mm	23 776
10 mm	23 778
11 mm	23 777
12 mm	23 775
13 mm	23 779
14 mm	23 773



#### 1/4" male TORX

E 4	23 788
E 5	23 790
E 6	23 792
E 8	23 794
E 10	23 796



#### 1/4" TORX

Head made of chrome silicon manganese molybdenum steel. Socket CrV steel.

TX 6	23 752
TX 8	23 753
TX 10	23 754
TX 15	23 756
TX 20	23 758
TX 25	23 760
TX 27	23 761
TX 30	23 762
TX 40	23 764



#### 1/4" flat screwdriver bit

Made of chrome silicon manganese molybdenum steel. Socket CrV steel.

4 mm	23 737
5.5 mm	23 739
7 mm	23 741
8 mm	23 742



#### 1/4" Philips screwdriver bit

Made of chrome silicon manganese molybdenum steel. Socket CrV steel.

No 1	23 730
No 2	23 731
No 3	23 732

#### 1/4" Pozidrive bit

Made of chrome silicon manganese molybdenum steel. Socket CrV steel.

No 1	23 733
No 2	23 735



#### MICRO 1/4" flex-head ratchet

Perfect fine-tooth ratcheting (72 teeth). One-finger reversing lever for changing ratcheting direction. Quick-release button releases socket instantly. Ideal for "tight spots" particularly on cars. Also suitable for bolts "around the corner". Produced using CrV steel with matt chrome-plated finish.

**NO 23 162**



#### MICRO bit 1/4" flex-head ratchet

With Allen ring for holding 1/4" standard bits. Distance from reversing lever to tip of bit only 35 mm. Otherwise same as described above.

**NO 23 158**

**Note:**  
See also Page 11.

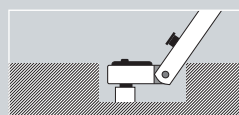
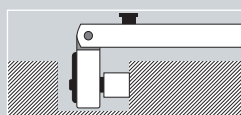

*The right tool for tight spots!*

# 3/8"

## Ratchets, sockets and accessories handy and compact

## for every user! 31 CrV 3 chrome-vanadium steel.

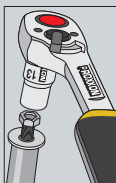

### Baton ratchet M (medium) 3/8". Our sturdy ratchet!

Fine tooth drive: Several teeth engage simultaneously for transferring maximum torque. Reversing lever for ratcheting direction. Quick-release button for releasing sockets instantly. Head and shaft forged from one piece of CrV steel. Double nickel-plated with matt chrome-plated finish. Grip of oil and acid resistant NEOPRENE with practical hole for hanging up.

**NO 23 332**

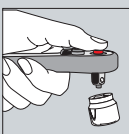

### Ratchet 2000 M (medium) 3/8". Our extremely flexible ratchet!

With handy, soft-touch Dupont HYTREL grip and practical hole for hanging up. Precision ratchet drive for long service life and high torque. Reversing lever for ratcheting direction. Quick-release button for releasing sockets instantly.

**NO 23 180**

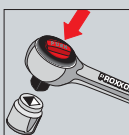

### Standard ratchet M (medium) 3/8". Proven 100,000 times over!

With reversing feature directly on ratchet mechanism. Several teeth engage simultaneously for transferring extremely high torque. Quick-release button for releasing sockets instantly. Head and shaft forged from one piece of CrV steel. Double nickel-plated with matt chrome-plated finish. Grip of oil and acid resistant NEOPRENE with practical hole for hanging up.

**NO 23 094**

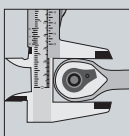

### MICRO ratchet M (medium) 3/8". The slender ratchet with fine teeth!

With extremely small head. Perfect fine-tooth drive for ratcheting action even when turned only 5°. Reversing lever for changing ratcheting direction. Quick-release button releases socket instantly. Head and shaft forged from one piece of CrV steel. Double nickel-plated with matt chrome-plated finish.

**NO 23 166**



**3/8" extension with slider**  
Adapter to 3/8" male square and 1/2" female square

Size	Part NO
200 mm	23 558



**3/8" extension**

75 mm	23 554
150 mm	23 556



**3/8" universal joint**

23 560



**3/8" adapter**  
3/8" female to 1/4" male square. (slider for 1/4" extension)

23 564



**3/8" adapter**  
3/8" female square drive to male 1/2" drive (slider for 1/2" extension)

23 566



**3/8" plug spanner**  
With NEOPRENE insert to grip plug.

16 mm	23 550
18 mm	23 551
21 mm	23 552





### 3/8" sockets

Size	Part NO
6 mm	23 500
7 mm	23 502
8 mm	23 504
9 mm	23 506
10 mm	23 508
11 mm	23 510
12 mm	23 512
13 mm	23 514
14 mm	23 516
15 mm	23 518
16 mm	23 520
17 mm	23 522
18 mm	23 523
19 mm	23 524
21 mm	23 526
22 mm	23 528
24 mm	23 530



### 3/8" deep sockets for protruding bolts

8 mm	23 532
9 mm	23 534
10 mm	23 536
11 mm	23 538
12 mm	23 540
13 mm	23 542
14 mm	23 543
15 mm	23 544
17 mm	23 546
18 mm	23 548
19 mm	23 549
22 mm	23 545
24 mm	23 547



### 3/8" Allen sockets – 80mm

Allen key made of chrome-silicon-manganese-molybdenum steel. Socket CrV steel.

4 mm	23 575
5 mm	23 576
6 mm	23 578
7 mm	23 579
8 mm	23 580
10 mm	23 581



### 3/8" TORX

Head made of chrome-silicon-manganese-molybdenum steel. Socket CrV steel.

TX 10	23 583
TX 20	23 584
TX 25	23 585
TX 27	23 586
TX 30	23 587
TX 40	23 588
TX 45	23 589
TX 50	23 590



### 3/8" flat screwdriver bit

Bit made of chrome-silicon-manganese-molybdenum steel. Socket CrV steel.

4 mm	23 591
5.5 mm	23 592
8 mm	23 593

### 3/8" philips screwdriver bit

Bit made of chrome-silicon-manganese-molybdenum steel. Socket CrV steel.

No 1	23 594
No 2	23 595
No 3	23 596



**PROXXON have been producing fine power tools for 25 years.**  
**Let us send you our full catalogue.**

There are more than 50 different tools in our range from the MICRO Engraving Pen GG 12, to our precision engineering lathe PD400, it is a real tool users treat.

For this 52 page catalogue call 01926 836906 or go to [www.brimarc.com](http://www.brimarc.com) for your copy.

UK Importer:

BriMarc Associates Ltd.  
Nick Lowe House,  
20A Harriott Drive  
WARWICK, CV34 6TJ

Tel: 01926 884440 Fax 01926 884444  
E-mail: [sales@brimarc.com](mailto:sales@brimarc.com)  
[www.brimarc.com](http://www.brimarc.com)



# 1/2"

## Ratchets, sockets and accessories for the

## most powerful socket. 31 CrV 3 chrome-vanadium steel.

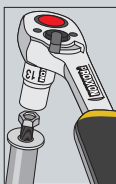

### Baton ratchet L (large) 1/2". Our sturdy ratchet!

Fine tooth drive: Several teeth engage simultaneously for transferring maximum torque. Reversing lever for ratcheting direction. Quick-release button for releasing sockets instantly. Head and shaft forged from one piece of CrV steel. Double nickel-plated with matt chrome-plated finish. Grip of oil and acid resistant NEOPRENE with practical hole for hanging up.

**NO 23 334**

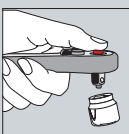

### Ratchet 2000 L (large) 1/2". Our extremely flexible ratchet!

With handy, soft-touch Dupont HYTREL grip and practical hole for hanging up. Precision ratchet drive for long service life and high torque. Reversing lever for ratcheting direction. Quick-release button for releasing sockets instantly.

**NO 23 190**



### Standard ratchet L (large) 1/2". Proven 100,000 times over!

With reversing feature directly on ratchet mechanism. Several teeth engage simultaneously for transferring extremely high torque. Quick-release button for releasing sockets instantly. Head and shaft forged from one piece of CrV steel. Double nickel-plated with matt chrome-plated finish. Grip of oil and acid resistant NEOPRENE with practical hole for hanging up.

**NO 23 096**

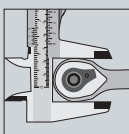

### MICRO ratchet L (large) 1/2". The slender ratchet with fine teeth!

With extremely small head. Perfect fine-tooth drive for ratcheting action even when turned only 5°. Reversing lever for changing ratcheting direction. Quick-release button releases socket instantly. Head and shaft forged from one piece of CrV steel. Double nickel-plated with matt chrome-plated finish.

**NO 23 168**



**1/2" T-bar extension**  
with adapter from 1/2" male to 3/8" female

Size	Part NO
250 mm	23 457



**1/2" extension**

64 mm	23 452
125 mm	23 454
250 mm	23 456



**1/2" female to 3/8" male square drive**  
(slider for 3/8" extension).

23 458



**1/2" universal joint**

23 450



**1/2" spark plug socket**

With NEOPRENE insert for holding spark plugs.

16 mm	23 442
18 mm	23 443
19 mm	23 445
21 mm	23 444



**1/2" spark plug socket with magnetic insert**

A powerful permanent magnet facilitates attachment and holds the spark plug tightly. See also Page 19.

16 mm	23 392
18 mm	23 394
21 mm	23 396



**1/2" slotted screw bit, 55mm**

Chrome-silicon manganese-molybdenum steel. CrV steel socket.

8 mm	23 462
10 mm	23 464

**1/2" Phillips screw bit, 55mm**

Chrome-silicon manganese-molybdenum steel. CrV steel socket.

No 2	23 470
No 3	23 472
No 4	23 474



**1/2" socket**  
With reduced drive and diameter  
(19mm and over).

Size	Part NO
8 mm	23 400
9 mm	23 402
10 mm	23 404
11 mm	23 406
12 mm	23 408
13 mm	23 410
14 mm	23 412
15 mm	23 414
16 mm	23 415
17 mm	23 416
18 mm	23 417
19 mm	23 418
21 mm	23 420
22 mm	23 422
23 mm	23 423
24 mm	23 424
27 mm	23 426
30 mm	23 428
32 mm	23 430
34 mm	23 431
36 mm	23 429



**1/2" deep sockets**  
for protruding bolts.

10 mm	23 355
11 mm	23 356
12 mm	23 357
13 mm	23 358
14 mm	23 359
15 mm	23 360
16 mm	23 361
17 mm	23 362
18 mm	23 363
19 mm	23 364
21 mm	23 365
22 mm	23 366
24 mm	23 367



**1/2" Allen sockets (55mm)**  
Allen key made of chrome-silicon-  
manganese-molybdenum steel,  
socket CrV steel.

5 mm	23 476
6 mm	23 477
7 mm	23 478
8 mm	23 479
10 mm	23 480
12 mm	23 481
14 mm	23 482

**1/2" Allen sockets (100mm)**  
Allen key made of chrome-silicon-  
manganese-molybdenum steel,  
socket CrV steel.

5 mm	23 484
6 mm	23 475
7 mm	23 485
8 mm	23 486
10 mm	23 487
12 mm	23 483



**1/2" external TORX sockets**

E 10	23 380
E 12	23 382
E 14	23 384
E 18	23 388



**1/2" TORX socket (55mm)**  
Head made of chrome-silicon-manganese-  
molybdenum steel, socket CrV steel.

TX 20	23 488
TX 25	23 489
TX 27	23 490
TX 30	23 491
TX 40	23 492
TX 45	23 493
TX 50	23 494
TX 55	23 446
TX 60	23 447

**1/2" TORX socket (100mm)**  
Head made of chrome-silicon-manganese-  
molybdenum steel, socket CrV steel

TX 40	23 495
TX 45	23 496
TX 50	23 497
TX 55	23 498
TX 60	23 499



**1/2" multi-toothed socket**  
for XZN bolts. Bit made of chrome-silicon-  
manganese-molybdenum steel, socket CrV  
steel.

VZ 6	23 370
VZ 8	23 371
VZ 10	23 372
VZ 12	23 373



**MICRO-Click torque wrenches with ratchet feature and autom**

**High accuracy in conforms with DIN/ISO.**

**2 YEAR ●  
GUARANTEE**

even when used professionally!

*Large, clearly legible scale for exact adjustment of desired torque by turning knurled adjustment ring on end of handle.*

*Ratchet mechanism with reversing lever for changing ratcheting direction.  
Automatic quick release: Clearly audible and perceptible "click" upon reaching set torque.*

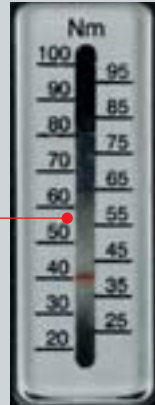

### **MICRO-Click 30/S Torque Wrench**

With 1/4" square drive to DIN 3120. For torques from 5 to 30Nm. For tightening all types of bolts up to M8 (13 mm head). Otherwise as described above.

**NO 23 349**

### **MICRO-Click 100/S Torque Wrench**

With 3/8" square drive to DIN 3120 (convertible for left-hand threads). For torques from 20 to 100Nm. Otherwise as described above.

**NO 23 351**

### **MICRO-Click 200/S Torque Wrench**

With 1/2" square drive to DIN 3120 (convertible for left-hand threads). For torques from 40 to 200Nm. Otherwise as described above.

**NO 23 353**



Torque can be set by turning the knurled ring at the end of the handle.  
Push in ring to arrest in set position.



atic release.



MICRO-Click torque wrenches are precision tools.  
Including practical plastic storage box.

MM	HEX	INHEX	FM-TX	M-TX	Nm
M 1,6	3,2	SW 1,5			-
M 2	4	SW 2	TX 6		-
2 - 2,5			TX 7		-
M 2,5	5	SW 2	TX 8		-
2,9 - 3			TX 9		-
M 3	5,5	SW 2,5	TX 10	E 4	-
(M 3,5)	6	-	TX 15		-
M 4	7	SW 3	TX 20	E 5	3
M 5	8	SW 4	TX 25	E 6	5,9
4,5 - 6			TX 27		
M 6	10	SW 5	TX 30	E 8	10
(M 7)	11	-	TX 40		-
M 8	13	SW 6	TX 40	E 10	25
8-10			TX 45		
M 10	(16) 17	SW 8	TX 50	E 12	49
M 12	(18) 19	SW 10	TX 55	E 14	85
(M 14)	(21) 22	SW 12	TX 60	E 18	135
M 16	24	SW 14	TX 70	E 20	210
(M 18)	27	SW 14	TX 80	E 24	300
M 20	30	SW 17	TX 90	E 24	425
(M 22)	(34) 32	-			580
M 24	36	SW 19			740

© by PROXXON

PROXXON INDUSTRIAL

Tightening torques for bolt shanks with standard metric threads (DIN 13, Part 13)  
and head contact dimensions (DIN 912, 931, 934)  
The friction co-efficient was determined using an untreated and unphosphatised bolt  
(screw-in state unlubricated, lightly oiled).

### Spark plug sockets with 1/2" magnetic inserts

Made of 31 CrV 3 chrome-vanadium steel. Powerful permanent magnet facilitates attachment and holds spark plugs tightly and securely. Double nickel-plated with single chrome-plated finish with easily legible socket size.



- NO 23 392 16mm
- NO 23 394 18mm
- NO 23 396 21mm



## Super Safety and Special Bit Set.

## Nothing is Impossible to Unscrew.

**2 YEAR  
GUARANTEE**

Even when used professionally  
**25 year guarantee** on all bits and adapters  
for material and workmanship.

**Deep hole bits (80mm)  
Normal bits (25mm)**

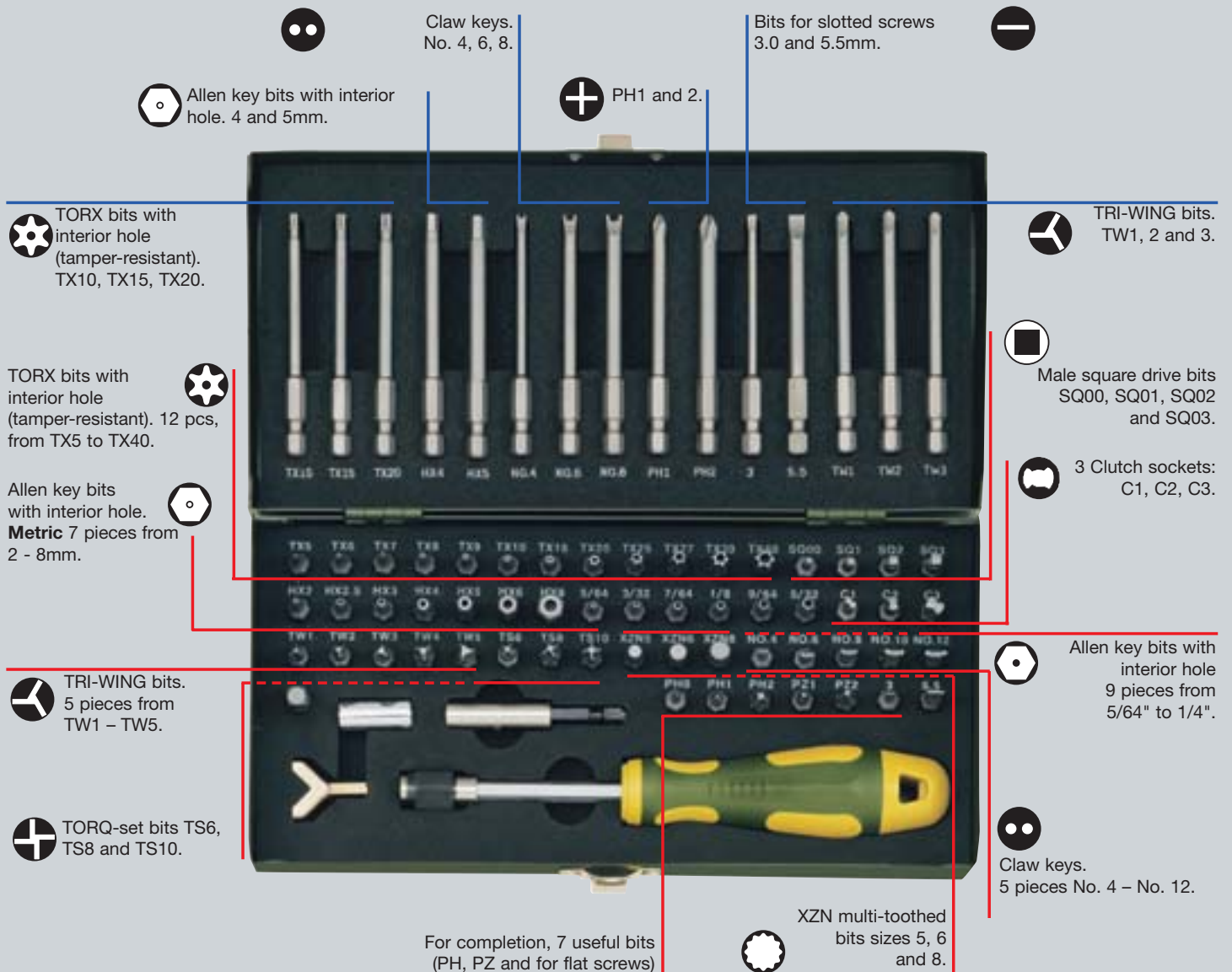

### Super safety and specialty bit set, 1/4" drive. 75-piece.

Absolutely industrial quality of special chrome-molybdenum-silicon-manganese-vanadium steel alloy. Sizes and shapes as described above. Including screwdriver with positive spring-sleeve holder for bits. Magnetic holder for work with electric screwdriver or drill. Adapter with male square and male hex. drive and mating

attachment with female square and female hex drive. Special attachment for centrally clamping screw hooks and similar parts. All in sturdy steel box (powder finish). Each part marked exactly and clearly.

**NO 23 107**



## ***SPEEDER ratchet spanners with reversing mechanism.***

***Reverse without turning over, easy, handy and economical!***

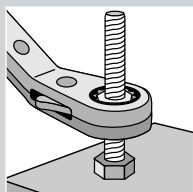

Hole allows long bolts to pass through when tightening nut. A tremendous time savings eliminating continuous removal and reattachment.

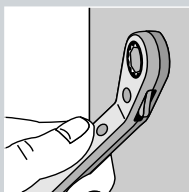

Head offset 25° for advantageous handling.

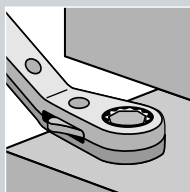

The SPEEDER shows its strengths in close quarters (particularly when attaching wrench).



### **SPEEDER set for hex. head bolts from 6 – 19mm.**

Sizes 6x7, 8x9, 10x11, 12x13, 14x15 and 17x19mm. Hardness, maximum torque and size accuracy according to DIN/ISO. Ring socket made of CrV steel. The set comes in a powder coated sturdy steel carry case.

**NO 23 231**

Even when used professionally!

**2 YEAR  
GUARANTEE**

### **SPEEDER ratchet spanners (single).**

<b>NO 23 201</b>	Speeder	Size 6 x 7
<b>NO 23 204</b>	Speeder	Size 8 x 9
<b>NO 23 205</b>	Speeder	Size 10 x 11
<b>NO 23 207</b>	Speeder	Size 10 x 13
<b>NO 23 209</b>	Speeder	Size 12 x 13

<b>NO 23 211</b>	Speeder	Size 14 x 15
<b>NO 23 214</b>	Speeder	Size 16 x 18
<b>NO 23 215</b>	Speeder	Size 17 x 19
<b>NO 23 216</b>	Speeder	Size 19 x 21

### ***Allen (HX) and TORX (TX) offset key sets***

***Special steel, for transferring high torques to Allen bolts.***



#### **Offset key set for Allen bolts (HX) 9-piece.**

1.5 – 2.0 – 2.5 – 3.0 – 4.0 – 5.0 – 6.0 – 8.0 and 10mm. Chrome-vanadium steel. In practical folding holder.

**NO 23 946**

#### **Offset key set for TORX screws (TX) 9-piece.**

One each TX8 – 10 – 15 – 20 – 25 – 27 – 30 – 40 and 50. Special nickel-chrome-molybdenum alloy steel. In practical folding holder.

**NO 23 944**

With 6-point spherical head on long shank. Short shank bevelled.



## MICRO-Speeder and MICRO-Combispeeder.

**Our test mechanics loved this spanner.**

**2 YEAR ●  
GUARANTEE**

Even when used professionally!

The ratchet feature is perfect in situations where conventional spanners cannot be turned.

The 72-tooth inner ring of special high alloy steel allows ratcheting even when the spanner can only be moved 5°. Nevertheless the torque transfer capacity far exceeds DIN/ISO standards. CrV steel shaft, chrome-plated, with a satin finish to pamper your skin.



The newly developed, encapsulated drive makes everything possible.



Extremely compact exterior measurements for the various sizes (A+B). Moreover very slender head.



**MIRCO-Speeder with straight, slender shape (without reversing mechanism - turn over to reverse). Ideal for "inserting" into tight spaces.**



### MICRO-Speeder

When things get really tight, the MICRO-Combispeeder (Fig. at right) is superior. On automatic transmissions, for removing engines, on rear axles, etc. Mechanism as described above.

NO 23 241	Size 8 x 9
NO 23 243	Size 10 x 11
NO 23 244	Size 10 x 13
NO 23 246	Size 12 x 13
NO 23 247	Size 14 x 15

NO 23 249	Size 16 x 18
NO 23 250	Size 17 x 19
NO 23 252	Size 22 x 24
NO 23 254	Size 27 x 30
NO 23 255	Size 32 x 34

#### Note:

The ratchet spanners offered here are extremely high quality tools with satin finish. The carefully encapsulated ratchet mechanism guarantees maximum service life.

**2 YEAR ●  
GUARANTEE**

Even when used professionally!

## **Advantages of new Combispeeder cap-stop system:**

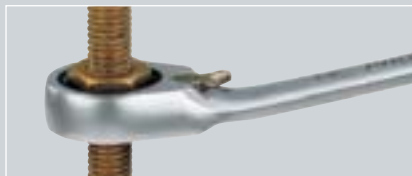

Holding the spanner in position is difficult on free-standing bolts.



With cap-stop: Simply move Combispeeder into position; a flange prevents slipping through.



## **MICRO-Combispeeder set, 6-piece**

One each 10, 13, 16, 17, 18 and 19mm in sturdy steel box (powder coated).  
**NO 23 124**

## **MICRO-Combispeeder with 15° offset on ring side and reversing lever for changing directions.**

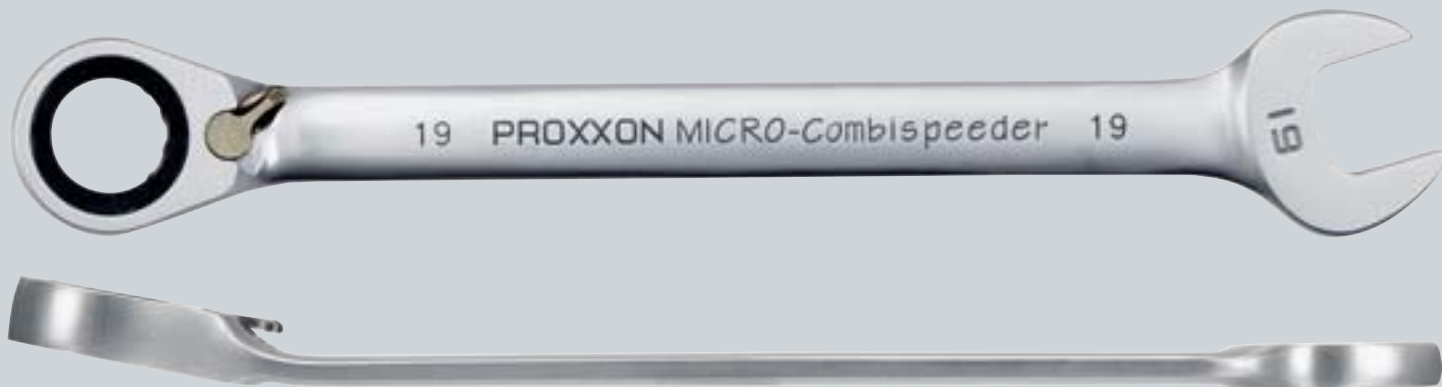

## **MICRO-Combispeeder**

It is not possible to turn over the 15° offset head. For this reason it is equipped with a reversing lever to change the ratcheting direction. Ideal for bolts on flat surfaces. Spanner design and mechanism as described above.

<b>NO 23 130</b>	Size 8
<b>NO 23 131</b>	Size 9
<b>NO 23 132</b>	Size 10
<b>NO 23 133</b>	Size 11
<b>NO 23 134</b>	Size 12
<b>NO 23 135</b>	Size 13
<b>NO 23 136</b>	Size 14
<b>NO 23 137</b>	Size 15

<b>NO 23 138</b>	Size 16
<b>NO 23 139</b>	Size 17
<b>NO 23 140</b>	Size 18
<b>NO 23 141</b>	Size 19
<b>NO 23 143</b>	Size 21
<b>NO 23 144</b>	Size 22
<b>NO 23 146</b>	Size 24

Slim-Line spanners- Tools to get to grips with.

10 YEAR  
GUARANTEE

Even with  
professional use

DIN

ISO

PROXXON

INDUSTRIAL

PROXXON INDUSTRIAL slim-line, top quality,  
yet competitively priced.

*Slim Line-combination spanner, 12 piece set  
complete with holder. To DIN 3113 and ISO  
3318. Ring head offset 15°.*

Includes 6 - 7 - 8 - 9 - 10 - 11 - 12 - 13 - 14 - 15 - 17  
and 19mm.  
Plastic holder with slot for each spanner and holes  
for attaching to wall. All spanners clearly labelled to  
make them easy to find.

*Slim Line - flat spanner set:  
Eight piece set to DIN 3110 and ISO  
3318, complete with holder.*

Includes 6 x 7, 8 x 9, 10 x 11, 12 x 13, 14 x 15, 16 x 17, 18 x 19  
and 20 x 22mm.  
Plastic holder with slot for each spanner and holes  
for attaching to wall. All spanners clearly labelled to make them easy to find.

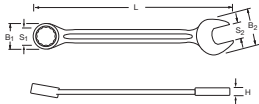

Nr 23 820 Complete

					
ring mouthed spanner					
S <sub>1</sub>	B <sub>1</sub>	B <sub>2</sub>	L	H	
23 905	5,5 mm	9	14	93	3
23 906	6 mm	10	16	100	3.4
23 907	7 mm	12	18	110	3.5
23 908	8 mm	13	20	120	3.5
23 909	9 mm	15	22	130	3.5
23 910	10 mm	16	23	140	4.0
23 911	11 mm	17	25	150	4.7
23 912	12 mm	19	27	160	4.7
23 913	13 mm	20	28	170	5.0
23 914	14 mm	22	31	180	5.0
23 915	15 mm	24	34	190	5.2
23 916	16 mm	25	36	195	5.2
23 917	17 mm	25	38	210	5.2
23 918	18 mm	28	39	216	6.5
23 919	19 mm	28	42	230	6.5
23 920	20 mm	30	45	250	6.5
23 921	21 mm	32	46	245	6.5
23 922	22 mm	33	49	270	6.5
23 924	24 mm	36	51	280	6.5
23 927	27 mm	39	55	310	7.7
23 930	30 mm	44	59	340	9.0
23 932	32 mm	46	64	360	9.0



NO 23 800 Complete





## Forged using CrV steel.

- Easy to grip, easy to handle and skin friendly plating, no sharp edges or sides.
- Polished, chrome-plated heads. Slim and thin-walled design for access in difficult places.
- Even though slim and light, the torque requirements of DIN/ISO are exceeded, because:

- The best steel is used for production: Chrome-vanadium alloy, drop forged and suitably hardened and treated.
- Exceeds DIN/ISO requirements for dimensional accuracy. Each piece is calibrated and checked.
- Optimum surface treatment against rust: Two layers of nickel plating and one of chrome.

### *Slim Line -ring spanners. Eight piece set complete with holder. To DIN 838 and ISO 3318 with 75° offset heads.*

Sizes 6 x 7, 8 x 9, 10 x 11, 12 x 13, 14 x 15, 16 x 17, 18 x 19, and 20 x 22mm. Plastic holder with slot for each spanner and holes for attaching to wall. All spanners clearly labelled to make them easy to find.



#### **TIP:**

The plastic holder for 8 and 12 piece sets is fitted with a plastic loop used for presentation purposes. It can be removed by simply bending it back and forth a few times.

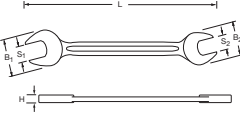
					
PROXON INDUSTRIAL Open-end spanners					
S <sub>1</sub> x S <sub>2</sub>	B <sub>1</sub>	B <sub>2</sub>	L	H	
23 828	5 x 5,5mm	13	14	111	3
23 830	6 x 7mm	16	18	123	3.4
23 832	8 x 9mm	20	22	145	3.5
23 834	10 x 11mm	24	26	157	4.0
23 836	12 x 13mm	28	29	173	4.7
23 838	10 x 13mm	24	29	174	4.7
23 840	14 x 15mm	32	34	190	5.0
23 842	16 x 17mm	36	38	205	5.2
23 846	18 x 19mm	38	42	220	5.7
23 848	17 x 19mm	33	42	220	5.7
23 850	20 x 22mm	43	46	235	6.5
23 852	21 x 23mm	45	48	248	6.5
23 856	24 x 27mm	49	55	268	6.5
23 860	30 x 32mm	59	64	302	9.0
23 864	34 x 36mm	65	79	320	10.0

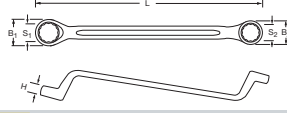
					
PROXON INDUSTRIAL Ring spanners					
S <sub>1</sub> x S <sub>2</sub>	B <sub>1</sub>	B <sub>2</sub>	L	H	
23 868	5 x 5,5mm	9	10	162	5
23 870	6 x 7mm	10	12	173	5.6
23 872	8 x 9mm	13	14	182	6.1
23 874	10 x 11mm	16	17	200	7.9
23 876	12 x 13mm	18	19	212	8.5
23 878	10 x 13mm	16	19	212	8.5
23 880	14 x 15mm	21	23	225	9.8
23 882	16 x 17mm	24	25	245	10.4
23 886	18 x 19mm	27	28	260	11.3
23 888	17 x 19mm	25	28	216	11.3
23 890	20 x 22mm	30	32	285	12.8
23 892	21 x 23mm	31	33	310	12.9
23 896	24 x 27mm	34	38	335	13.9
23 900	30 x 32mm	42	45	375	15.3

NO 23 810 Complete



## Slim Line - Spanners.

**Tools to get to grips with. Bulk packed complete sets for trade and industry.  
Top quality and very reasonably priced!**

**DIN  
ISO**

**10 YEAR  
GUARANTEE**

Even when used professionally!

- Easier to grip, easy to hold shaft with skin friendly surface (Satin-finish). No sharp edges or trims.
- Slim, polished, chromed heads.
- Reduces problems with hard-to-reach nuts. Although extremely thin and light, torque values far exceed DIN/ISO specifications.
- Optimum surface treatment against rust: Two layers of nickel plating and one of chrome.

**Slim Line - Double open-end spanner set: 11 pieces 6 – 32mm.**

**Meet DIN 3110 and ISO 3318.**

Sizes 6 x 7, 8 x 9, 10 x 11, 12 x 13, 14 x 15, 16 x 17, 18 x 19, 20 x 22, 21 x 23, 24 x 27, and 30 x 32mm.

Set of 11 spanners in box.

**NO 23 802**

**Slim Line - Open-end/ring spanner set: 21 pieces**

Sizes 6, 7, 8, 9, 10, 11, 12, 13, 14, 15, 16, 17, 18, 19, 20, 21, 22, 24, 27, 30 and 32mm.

Set of 21 spanners in box.

**NO 23 822**

**Slim Line - Double ring spanner set: 11 pieces.**

6 – 32mm. Sizes 6 x 7, 8 x 9, 10 x 11, 12 x 13, 14 x 15, 16 x 17, 18 x 19, 20 x 22, 21 x 23, 24 x 27 and 30 x 32mm.

Set of 11 spanners in box.

**NO 23 812**



**Impact socket set. For compressed air impact nut runners (1/2"). 24 pieces.**

**25 YEAR  
GUARANTEE**

Even when used professionally!



Forged from top quality chrome-molybdenum, nickel and manganese alloy for extreme wear resistance and maximum torque up to 500Nm.

Complete contents: 10, 12, 13, 14, 15, 16, 17, 18, 19, 21, 22 and 24mm standard sockets (38mm) as well as deep sockets (78mm) with same sizes eliminating inconvenient extensions with retaining springs.

In sturdy, powder finished steel case.

**NO 23 942**

**UK Importer:**

**BriMarc Associates Ltd. • Nick Lowe House, 20A Harriott Drive • Heathcote Industrial Estate •  
WARWICK, CV34 6TJ**

**Tel 01926 884440 • Fax: 01926 884444**